

LED PANEL SQUARE 30x30

Led type	2835
Power	18 W
CRI	>80
Beam Angle	110°
PF	>95
Frame	White or Silver
Warranty	2 years



Model number	Description	Color	Power	Lumen/mt
BOLOGNAW18WATT	Led Panel 30x30 110-240 V AC	5000 K	18 W	1116
BOLOGNANW18WATT	Led Panel 30x30 110-240 V AC	4000 K	18 W	1170
BOLOGNAWW18WATT	Led Panel 30x30 110-240 V AC	3000 K	18 W	1018

* Driver included

SAFETY INFORMATION

- Please confirm the applicable power supply before using.
- Make sure the switch of product is off before connect to the power supply to prevent electric shock.
- Operation against rules may damage your property and even harm to your personal safety.
- Preliminarily estimate required quantity of LED panel lights, then according to the power rating of single panel light to figure out the total power and design power supply plan.
- Dangerous high voltage, Non-professionals are not allowed to maintain the products.
- If the exterior flexible cable or wire is damaged, it must exchange by the supplier, or other qualified personnels to avoid dangers.

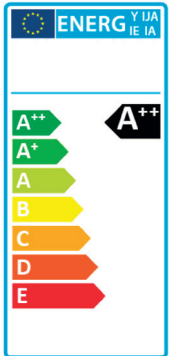

APPLICATION

This type of panel can be used in hotels, meeting rooms, factories, offices, commercial purposes, residential, institution buildings, schools, hospitals, places which needs energy saving and high color rendering index lighting.

ADVANTAGES

- Visual uniformity
- Low glare lighting
- Led efficiency
- Cost and energy saving
- Long life time

INSTALLATION

Schematic diagram for embedded installation

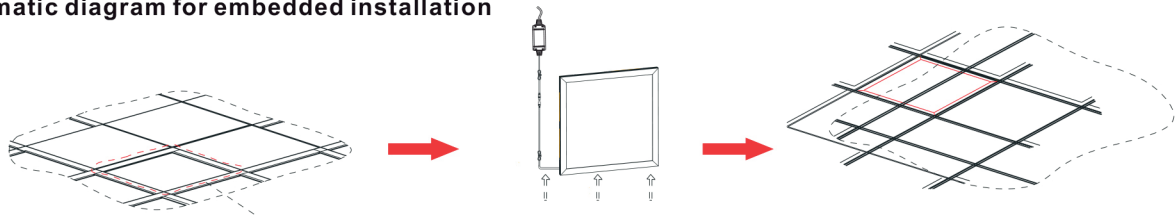

1. move away ceiling plaster slab, then arrange the wire.

2. put through the panel light along ceiling's diagonal and then wiring.

3. fix the panel light to suitable place

Schematic diagram for ceiling installation

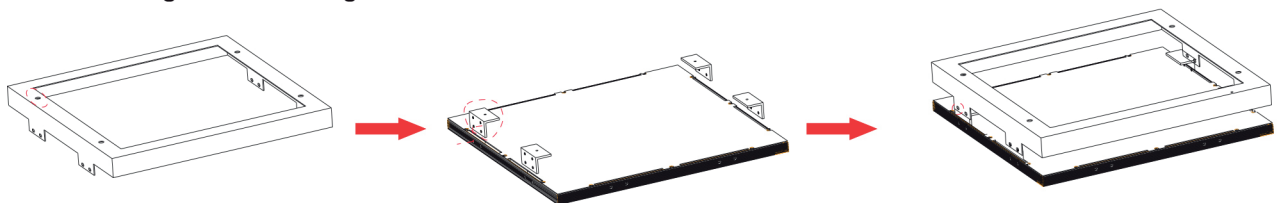

1. fix the upper frame

2. install connection fittings

3. laterally connect panel light to upper frame by screws

Schematic diagram for vertical installation

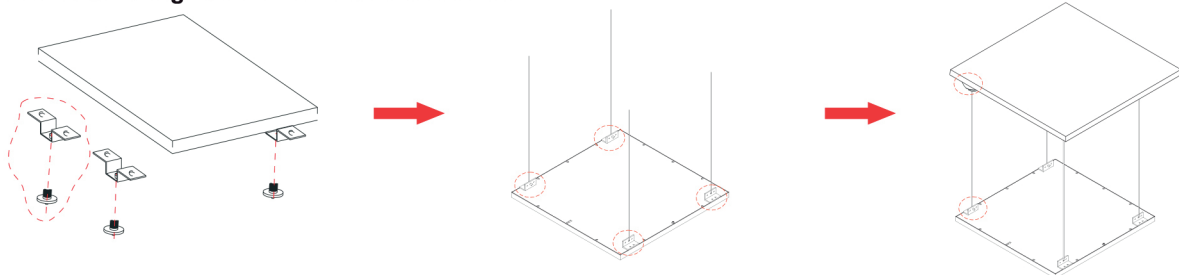

1. install the hanging fixed block in order.

2. set up hanging fittings stainless steel rope

3. fix the rope on suitable height by using lifter.